



Alex & Matteo
ESTATE AGENTS



Acorn Walk, London, SE16 5DY

Guide price £325,000 to £350,000

A spacious one bedroom apartment located in the peaceful Rotherhithe. The apartment boasts a generous naturally bright living room with access to a private balcony, separate modern kitchen, a large double bedroom with built-in storage, and a stylish bathroom. The surrounding area features a plethora of local amenities such as restaurants, bars, and convenience store; as well as being a short walk away from both Rotherhithe Pier, with ferry access to Canary Wharf, good bus links into central London, and the greenery of Stave Hill Ecological Park.

Years On Lease - 85 to be extended to 175
Annual Service Charge - £2,002.20
Annual Ground Rent - Peppercorn
Council Tax Band - C

Council tax, property size and, where applicable, lease information, service charges and ground rent are given as a guide only and should always be checked and confirmed by your Solicitor prior to exchange of contracts.

- Chain Free
- Spacious One Bedroom Apartment
- Naturally Bright
- Private Balcony
- Car Parking Space
- Excellent Location
- Good Transport Links
- Close to Local Amenities

Alex & Matteo
ESTATE AGENTS

Guide price £325,000

Cherry Court SE16

Approximate Area = 566 sq ft / 52.5 sq m

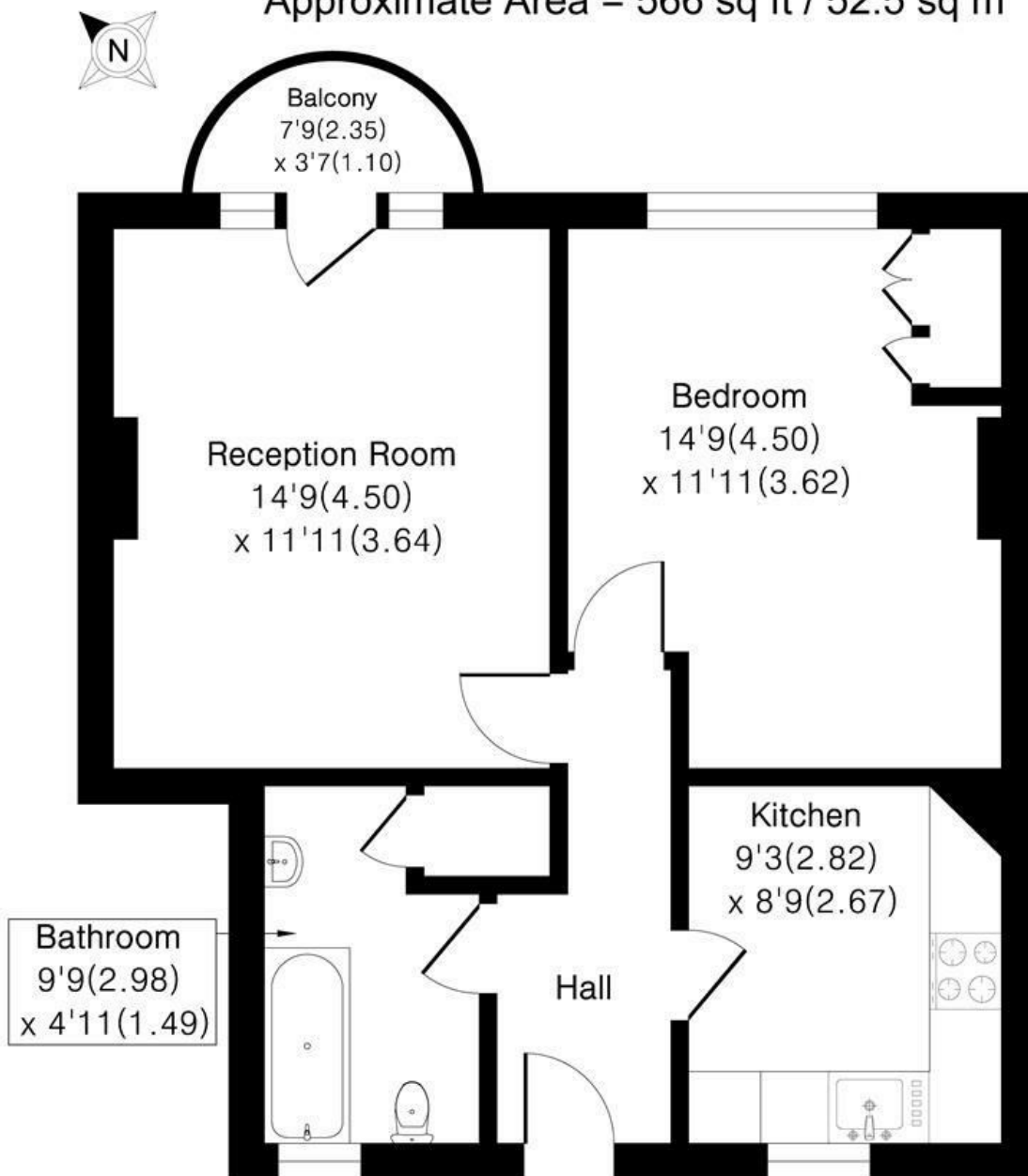

First Floor



Floor plan Produced in accordance with RICS Property Measurement 2nd Edition.
Incorporating International Property Measurement Standards (IPMS2 Residential).
Produced for Alex & Matteo Estate Agents.

Energy Efficiency Rating		
	Current	Potential
Very energy efficient - lower running costs		
(92 plus) A		
(81-91) B		84
(69-80) C		
(55-68) D	65	
(39-54) E		
(21-38) F		
(1-20) G		
Not energy efficient - higher running costs		
England & Wales EU Directive 2002/91/EC		